

HEAT PRESS MANUAL

Scan for Operation video →

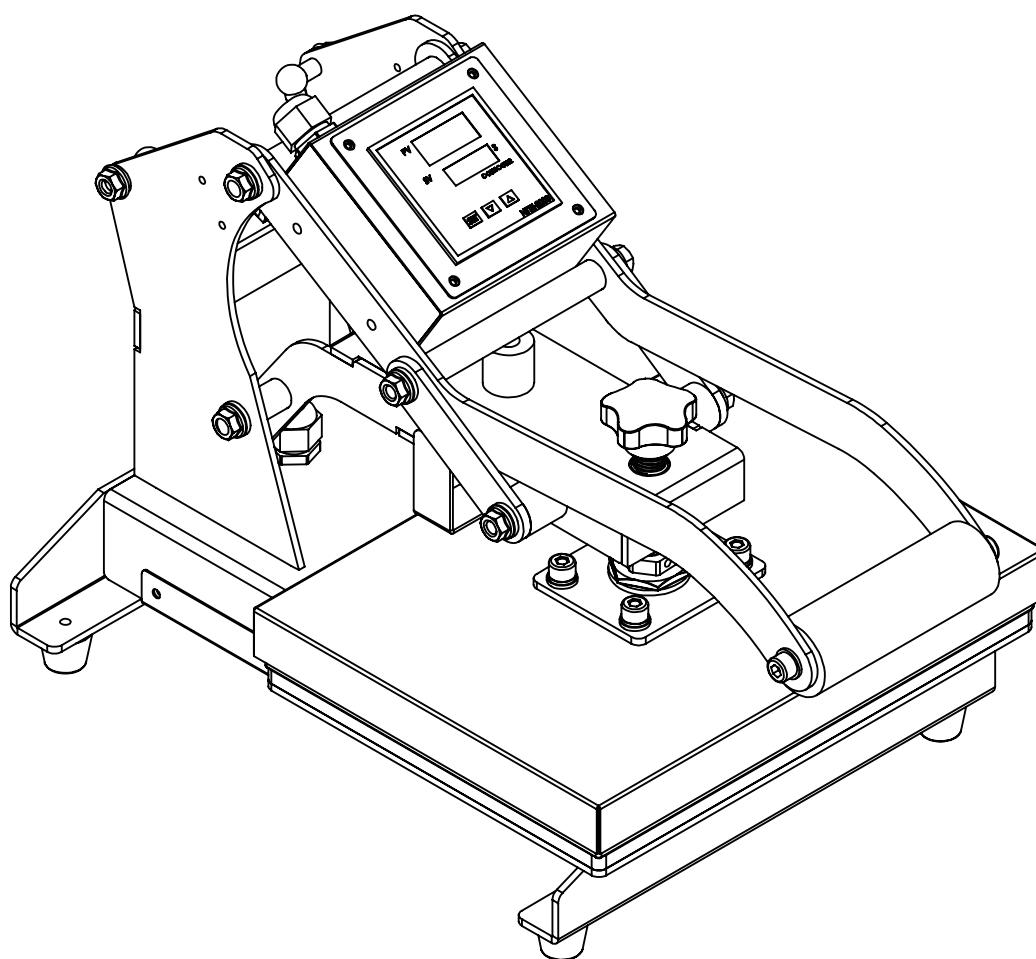

Model: Magic Press Pro 2330

CONTENTS:

1.Machine Main Technical Parameters-----	1
2.Machine Operating Instruction-----	2
3.Circuit Dia -----	3

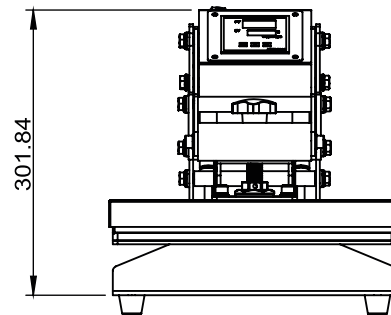
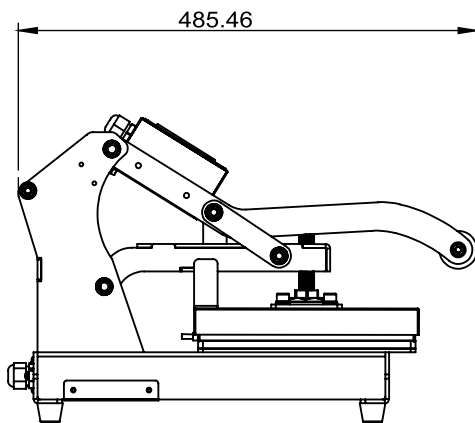
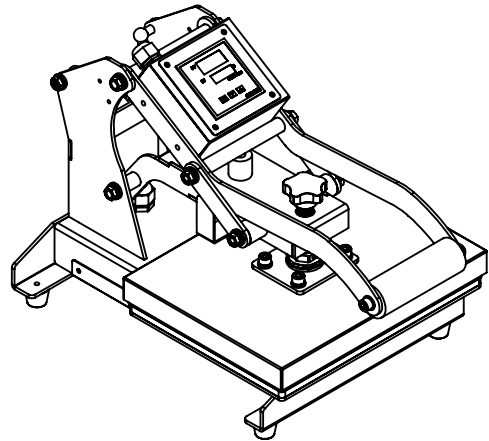
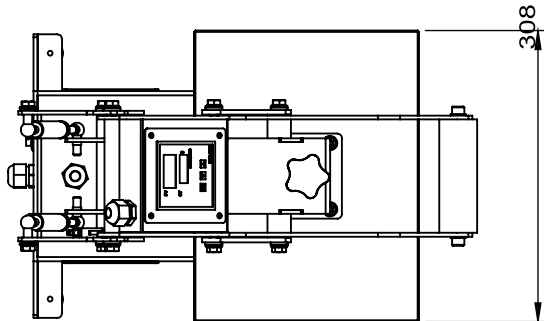

Technical Parameters

1. Model No: Magic Press Pro 2330
2. Machine Dimensions :485*308*300mm
3. Heat Platen Size :230*300mm
4. Printable Articles Max Size:230*300mm
5. Voltage: 220v to 240v
6. Vinyl Recommend Setting: Time:8s; Temp:160
7. Packing size:565*365*380mm
8. Gross weight: 16kgs

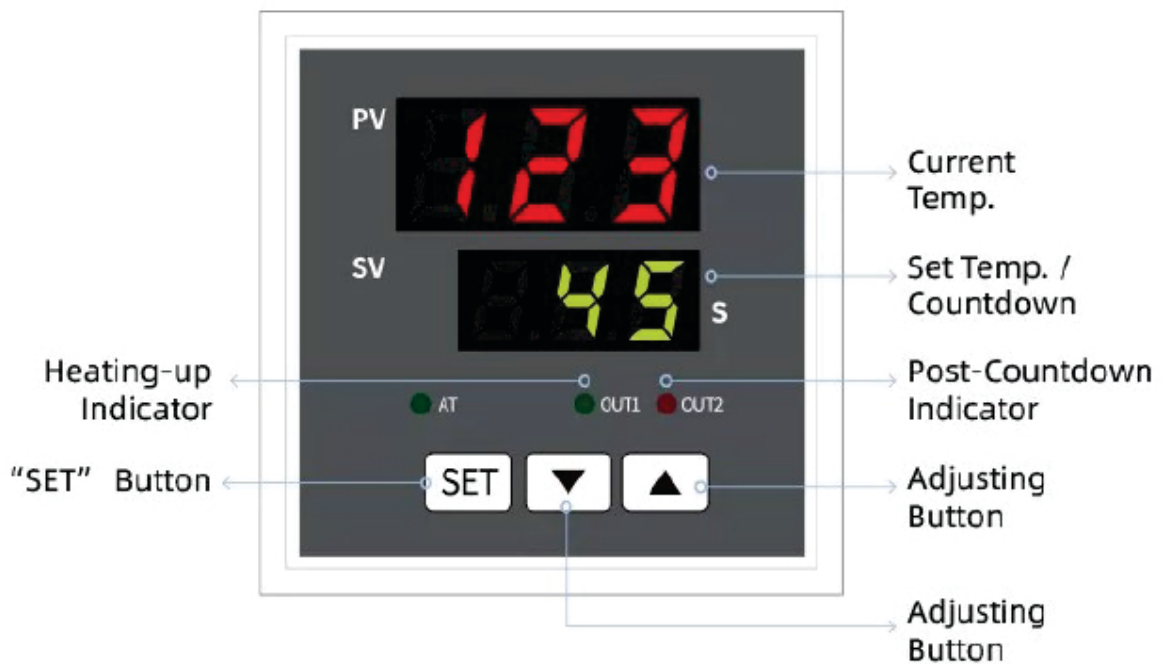

How to program the Heat Press machine

STEP 1: Make sure the cord is connected well to the wall socket. Lift up on the handle to open the press. The press should always be in the open position when the press is heating. then draw out the under plate and place the object (i.e., T-shirt, Mouse Pad, etc.) and transfer paper with images or garment vinyl facing down the object, adjust the pressure to be moderate, and switch on the press.

STEP 2: Press **SET** button to enter temperature setting mode, then press “ ” or “ ” button to adjust the temperature.

STEP 3: Press **SET** button again to enter time setting mode, then press “ ” or “ ” button to adjust the time.

Press **SET** button third time to save the settings.

STEP 4: When **SET** the temperature, close the heat press, time is counting down; once the time is up, then the machine will "beep", you can open the heat press and all done.

STEP 5:

Circuit Dia

